

MU 23-3-X

Colinear 3 dB Mobile Antenna for the 23 cm Amateur Band: 1240–1300 MHz



DESCRIPTION:

- ★ 3 dB colinear whip comprising a $3/8 \lambda$ section, a phasing coil and a $5/8 \lambda$ section.
- ★ All materials in top professional quality.
- ★ Broadband-performance 1240-1300 MHz – no tuning required.
- ★ Stainless steel X-mount with M6-thread whip-fastening system.
- ★ Simple mounting in an 18 mm hole with access from the outside only.
- ★ Models available with X-mount (oblong), CX-mount (circular) and MM-mount (magnetic).
- ★ Choice between two connection principles:
 - ★ X-mount, MM-mount : FME-connection (supplied without cable).
 - ★ XP4-mount : Permanently attached 4 m low-loss RG 58 cable terminated with FME-connector.

FME-SYSTEM ACCESSORIES	
FME-CABLES	
LENGTH	TYPE NO.
1m	1m FME
2m	2m FME
3m	3m FME
4m	4m FME
5m	5m FME
6m	6m FME
4m white	4m FME-white
6m white	6m FME-white
12m white	12m FME-white
18m white	18m FME-white

For further information about other types of FME-cables please compare the cable data sheets under accessories in our catalogue.

FME-SYSTEM ACCESSORIES	
FME-CONNECTORS	
CONNECTOR	ORDER NO.
FME-FME	FME-FME
Prolongation	FMEP
N	FME-N
FSMA	FME-FSMA
BNC	FME-BNC
TNC	FME-TNC
UHF	FME-UHF
Mini-UHF	FME-MUHF
Elbow-MUHF	FME-EMUHF
Elbow-BNC	FME-EBNC
Elbow-TNC	FME-ETNC
SMA	FME-SMA

SPECIFICATIONS:

ELECTRICAL	
MODEL	MU 23-3-X
ANTENNA TYPE	Colinear mobile antenna
FREQUENCY	23 cm amateur band: 1240–1300 MHz
IMPEDANCE	Nom. 50 Ω
POLARISATION	Vertical
GAIN	3 dB (acc. to EIA RS-329-1)
BAND WIDTH	≥ 60 MHz @ SWR ≤ 2.0
SWR	≤ 1.5 @ f. res.
MAX. POWER	40 watts
MECHANICAL	
MATERIALS	Whip: Black-chromed stainless steel and brass Mount: Black-chromed brass Environment-proof plastics Stainless steel
RECOMMENDED INSTALLATION TORQUE	4 ± 1 Nm
COLOUR	Black
HEIGHT	Approx. 22 cm
WEIGHT	X-version : Approx. 60 g XP4-version : Approx. 200 g MM-version : Approx. 230 g
MOUNTING	18 mm dia. hole

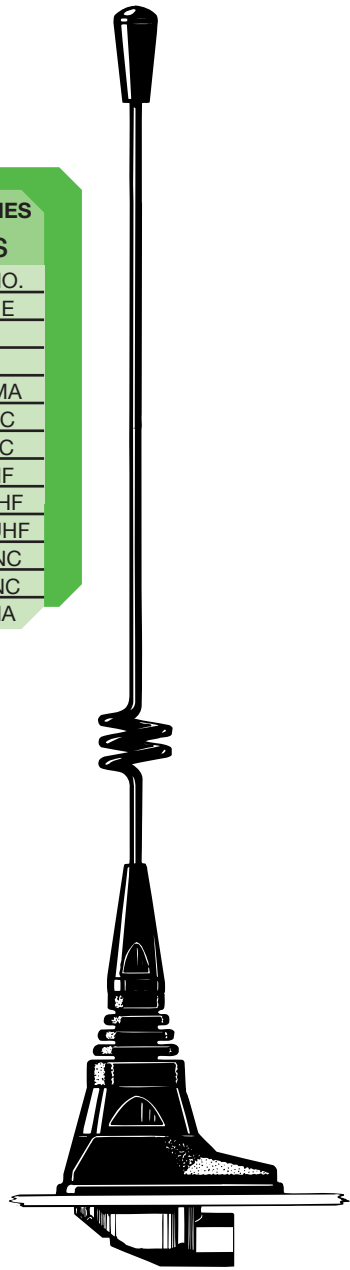

X-Mount

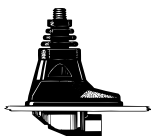

CX-Mount

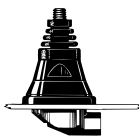

XP4-Mount

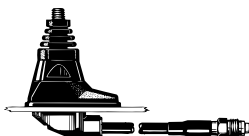

CXP4-Mount

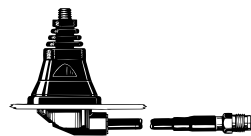

MM-Mount

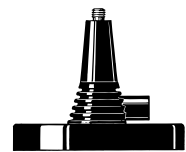

ORDERING DESIGNATIONS:

MOUNT VERSION	X-mount (oblong) with FME-system	CX-mount (circular) with FME-system + FME-connector	XP4-mount (oblong) with 4 m cable + FME-connector	CXP4-mount (circular) with 4 m cable	MM-mount (magnetic) with FME-system
TYPE NO.	MU 23-3-X	MU 23-3-CX	MU 23-3-XP4	MU 23-3-CXP4	MU 23-3-MM

PROCOM A/S reserve the right to amend specifications without prior notice.

MU 23-3-X Installation



This antenna should be mounted on the car roof to ensure best omnidirectional coverage.

Mounting can take place exclusively with access from the outside when drilling an 18 mm dia. hole. Mounting can take place from the inside by drilling a 14 mm dia. hole. When mounting in a 14 mm dia. hole, remove the bottom plastic ring of the packing gasket with a sharp cutter.

When cleaning the car in car-washing machines, remove the whip using a spanner, size 9 mm. After wash, refit the whip and tighten it lightly with the spanner.

The MiniMag (abbreviated: MM) is a small, light-weight magnetic mount with a high attaching effect. A silicone layer applied to the contact surface protects the car roof and ensures maximum friction.

1. INSTALLATION DIMENSIONS:

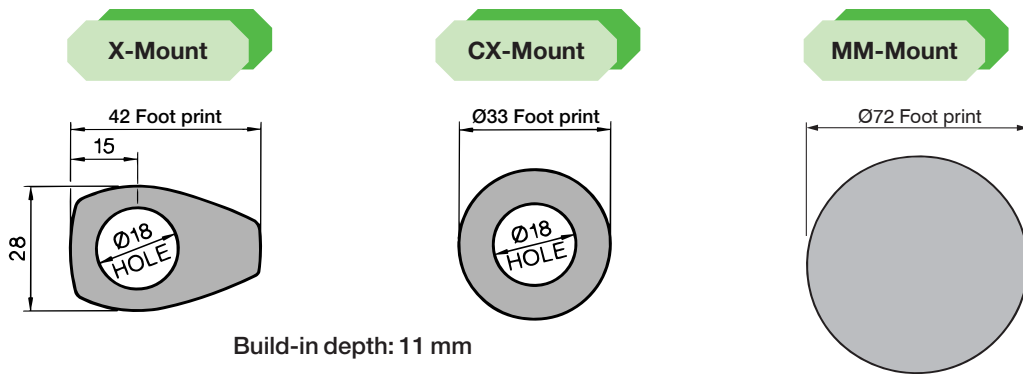

2. INSTALLATION STEPS:

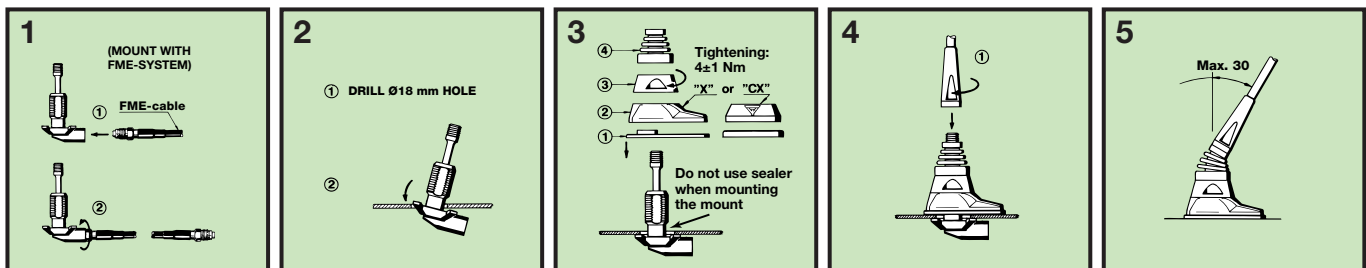

3. TUNING:

The antenna is delivered factory-tuned and requires no further tuning.

PLEASE NOTE:

For safety reasons:

1. When using the MU 23-3-MM, car speed must not exceed 130 km/h.
2. If operating the MM-mount with other whips, whip length must never exceed 320 mm, and utilizing this maximum length, car speed must not exceed 115 km/h.