

MU 4-X/...

Colinear 4 dB Mobile Antenna for the 450 MHz Band



DESCRIPTION:

- ★ 4 dB mobile antenna with colinear, stainless steel whip.
- ★ Stainless steel X-mount with M6-thread whip-fastening system.
- ★ Models available with X-mount (oblong), CX-mount (circular) and MM-mount (magnetic).
- ★ Choice between mounts with FME-connection (without cable) or models with permanently attached 4 m cable with FME connector.
- ★ Choice between general purpose tunable models and permanently tuned models for cellular systems.

SPECIFICATIONS:

ELECTRICAL	
MODEL	MU 4-X/...
ANTENNA TYPE	Colinear stainless steel mobile whip antenna
FREQUENCY	Models within 380–470 MHz
IMPEDANCE	Nom. 50 Ω
POLARISATION	Vertical
GAIN	4 dB (acc. to EIA RS-329-1)
BAND WIDTH	> 15 MHz @ SWR ≤ 1.5
SWR	≤ 1.3 @ f. res.
MAX. POWER	100 watts
MECHANICAL	
MATERIALS	Whip: Black-chromed stainless steel Black-chromed brass Mount: Black-chromed brass Environment-proof plastics. Stainless steel
RECOMMENDED INSTALLATION TORQUE	4 ± 1 Nm
COLOUR	Black
HEIGHT	Approx. 59 cm (dep. on freq.)
WEIGHT	X-version : Approx. 150 g XP4-version : Approx. 290 g MM-version : Approx. 400 g
MOUNTING	18 mm dia. hole

To help selecting the correct model for a specific cellular network, please consult the survey of cellular network frequencies under USEFUL DATA in our catalogues.

All whips are compatible with all mounts.

X-Mount

CX-Mount

XP4-Mount

CXP4-Mount

MM-Mount

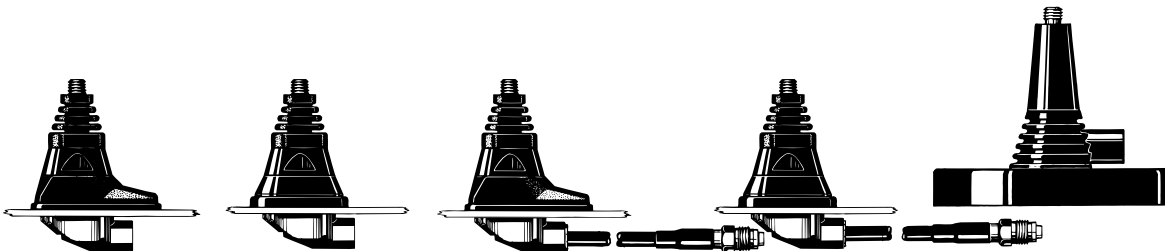

ORDERING DESIGNATIONS:

MOUNT VERSION	X-mount (oblong) with FME-system	CX-mount (circular) with FME-system	XP4-mount (oblong) with 4 m cable and FME-connector	CXP4-mount (circular) with 4 m cable and FME-connector	MM-mount (magnetic) with FME-system
TUNING RANGE	Models for general application – tunable with adjustment disc:				
380...410 MHz	MU 4-X/s	MU 4-CX/s	MU 4-XP4/s	MU 4-CXP4/s	MU 4-MM/s
406...430 MHz	MU 4-X/f	MU 4-CX/f	MU 4-XP4/f	MU 4-CXP4/f	MU 4-MM/f
420...450 MHz	MU 4-X/l	MU 4-CX/l	MU 4-XP4/l	MU 4-CXP4/l	MU 4-MM/l
440...470 MHz	MU 4-X/h	MU 4-CX/h	MU 4-XP4/h	MU 4-CXP4/h	MU 4-MM/h
FREQUENCY RANGE	Models for cellular systems – pretuned, without adjustment disc:				
380–400 MHz	MU 4-X/CEL5	MU 4-CX/CEL5	MU 4-XP4/CEL5	MU 4-CXP4/CEL5	MU 4-MM/CEL5
414–430 MHz	MU 4-X/CEL4	MU 4-CX/CEL4	MU 4-XP4/CEL4	MU 4-CXP4/CEL4	MU 4-MM/CEL4
425–440 MHz	MU 4-X/CEL3	MU 4-CX/CEL3	MU 4-XP4/CEL3	MU 4-CXP4/CEL3	MU 4-MM/CEL3
440–455 MHz	MU 4-X/CEL2	MU 4-CX/CEL2	MU 4-XP4/CEL2	MU 4-CXP4/CEL2	MU 4-MM/CEL2
450–470 MHz	MU 4-X/CEL1	MU 4-CX/CEL1	MU 4-XP4/CEL1	MU 4-CXP4/CEL1	MU 4-MM/CEL1

PROCOM A/S reserve the right to amend specifications without prior notice.

MU 4-X/... Installation



The X- and CX-antenna types can be mounted anywhere on the car, however, roof top mounting is always recommended. The oblong X-mount can be mounted on the often very narrow strip on the rear wing between the trunk lid and the side of the car. Mounting can take place exclusively with access from the outside when drilling an 18 mm dia. hole. Mounting can take place from the inside by drilling a 14 mm dia. hole. When mounting in a 14 mm dia. hole, remove the bottom plastic ring of the packing gasket with a sharp cutter.

When cleaning the car in car-washing machines, remove the whip using a spanner, size 9 mm. After wash, refit the whip and tighten it lightly with the spanner.

As the X- and CX-mounts are internally equipped with a bendable section, the antennas can always be adjusted to an upright position independent of the tilt angle of the installation spot.

The MiniMag (abbreviated: MM) is a small, light-weight magnetic mount with a high attaching effect. A silicone layer applied to the contact surface protects the car roof and ensures maximum friction.

Antennas with magnetic mount should be mounted in the middle of the vehicle roof to ensure best omnidirectional coverage. Within this antenna series, all whips are compatible with all mounts.

1. INSTALLATION DIMENSIONS:

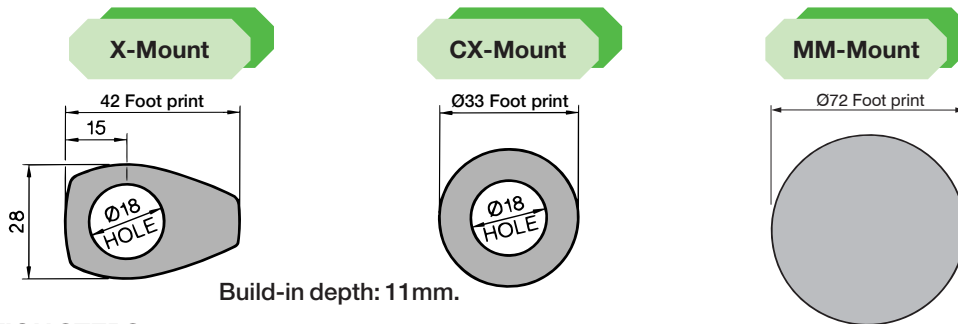

2. INSTALLATION STEPS:

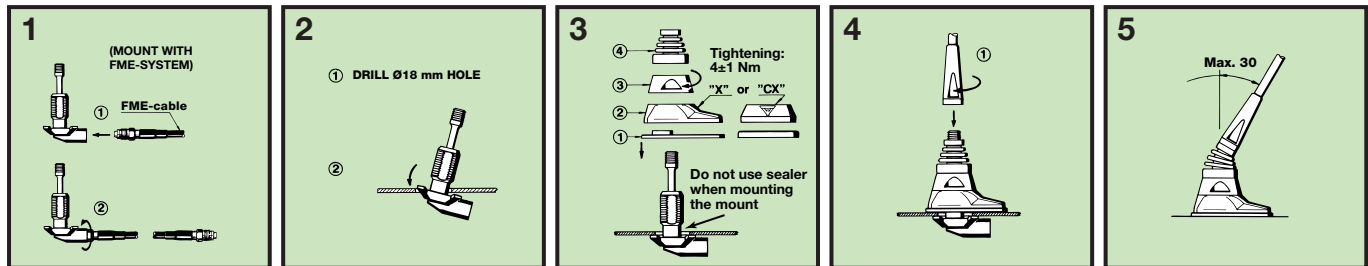

3. TUNING:

The diagrams apply to all models in the series

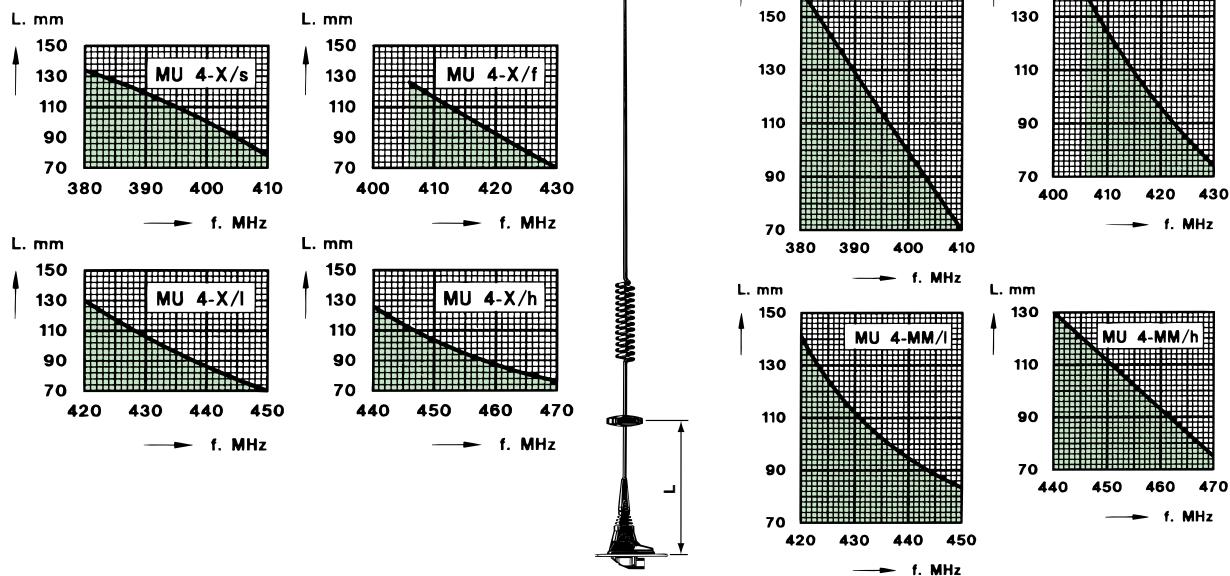

PLEASE NOTE:

For safety reasons:
When using the MU 4-MM, car speed must not exceed 120 km/h.