

GPS-C R/DAB/FM

GPS Antenna with a 1/4 λ Whip with Shock Spring for the DAB and FM Bands

DESCRIPTION

- GPS-antenna for fixed installations.
- External antenna whip mounted on the GPS-Combi mount.
- Full hemispherical coverage.
- Built-in high gain, low noise amplifier.
- Right-Hand Circular Polarisation (RHCP).
- 5 V supply voltage (3 V respectively 12 V available on request).
- DC supply via RF-connector.
- Black-chromed, conical stainless steel whip.
- Sturdy, general-purpose 1/4 λ antenna in professional quality.



SPECIFICATIONS FOR WHIP

ELECTRICAL	
MODEL	GPS-C R/DAB/FM
ANTENNA TYPE	1/4 λ mobile antenna
FREQUENCY	DAB-Band (223 – 240 MHz) also receives FM band (88 - 108 MHz)
IMPEDANCE	Nom. 50 Ω
POLARISATION	Vertical
GAIN	0 dB (acc. to EIA RS-329-1)
SWR	≤ 1.3 @ f. res.
MECHANICAL	
MATERIALS	Whip: Black-chromed, conical stainless steel Black-chromed brass Spring: Black-chromed stainless steel
COLOUR	Black
HEIGHT	Approx. 290 mm
WEIGHT	Approx. 50 g
MOUNTING	On the GPS-Combi mount

SPECIFICATIONS FOR GPS-COMBI MOUNT

ELECTRICAL General specifications	
MODEL	GPS-COMBI MOUNT
ANTENNA TYPE	Active patch antenna
FREQUENCY	1575 MHz
IMPEDANCE	Nom. 50 Ω
POLARISATION	Circular right-hand
COVERAGE	Hemispherical
GAIN	28 dBic in axial direction (typ.)
CROSS-POLARISATION ATT.	> 10 dB (typ.)
BUILT-IN AMPLIFIER	
GAIN	> 30 dB (typ.)
NOISE FIGURE	< 1 dB (typ.)
P 1dB	Approx. +7 dBm
SELECTIVITY	> 45 dB down at ± 45 MHz
SWR (output)	≤ 2.0
SUPPLY VOLTAGE	5 ± 0.5 VDC (3 V resp. 12 V on request)
CURRENT CONSUMPTION	Approx. 25 mA
MECHANICAL (only for the GPS-part)	
MATERIALS	Cu-nite brass Stainless steel Reinforced thermoplastic
ANTENNA COLOUR	Black
TEMP. RANGE	-35° C → +75° C
CONNECTOR	FME (male for GPS) + FME (female for mobile antenna)
RECOMMENDED INSTALL. TORQUE	4 ± 0.5 Nm
DIMENSIONS(H x L)	Approx. 30 x 89 mm
ROOF THICKNESS	Max. 2.0 mm
WEIGHT	Approx. 114 g
MOUNTING	ø18 mm dia. hole (For roof thickness 2.5 mm mounting hole should be ø18.5 mm dia.) Tools for mounting included

MOUNTING INSTRUCTIONS

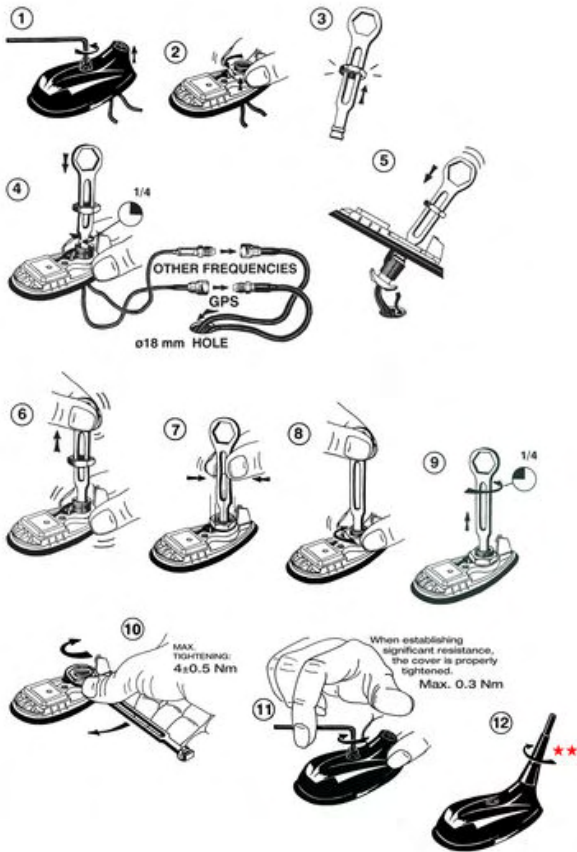

CABLE MOUNTING

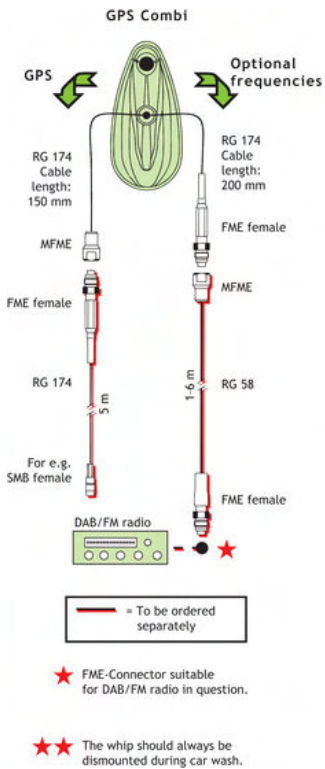

Do not use sealer on rubbergasket or other places.

TYPICAL RESPONSE CURVE

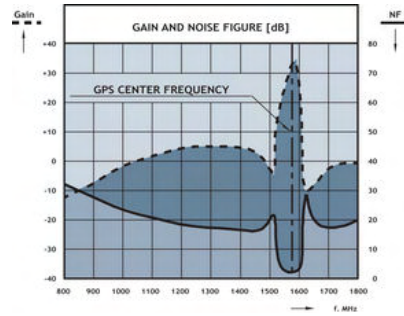
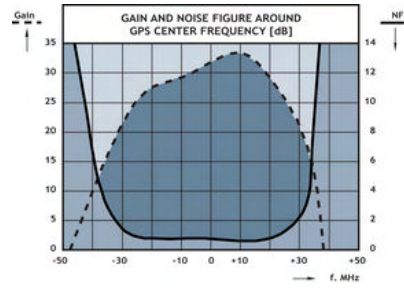

TYPICAL RADIATION PATTERN

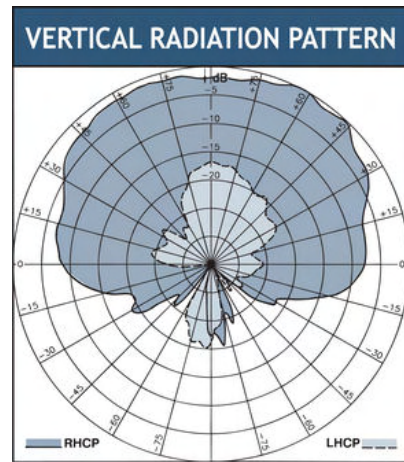

PROCOM A/S reserve the right to amend specifications without prior notice.

06/05/2009