

MH 1-SMR

1/4 λ Mobile Antenna for the 160 MHz Band

DESCRIPTION

- Black-chromed, conical stainless steel whip.
- Elegantly designed SM-mount especially suited for mounting on the curved wings.
- Supplied with three different packing gaskets for optimum adjustment to the wing contour.
- M6-thread whip-fastening system. Mount provided with FME-connection (supplied without cable).



PACKING GASKETS

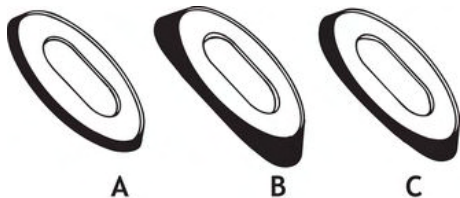

ORDERING DESIGNATIONS

As standard, the antenna **MH 1-SMR** is delivered tunable by cutting within the 160 MHz band (144...175 MHz).

The antenna can also be delivered factory tuned. Please consult our price list concerning additional charges for adjustment by cutting.

SPECIFICATIONS

ELECTRICAL	
MODEL	ML 1-SMR
ANTENNA TYPE	1/4 λ mobile whip antenna
FREQUENCY	Tunable by cutting within: 144...175 MHz (Also applicable: 175...225 MHz)
IMPEDANCE	Nom. 50 Ω
POLARISATION	Vertical
GAIN	0 dB (1/4 λ antenna)
BAND WIDTH	≥ 20 MHz @ SWR ≤ 2.0
SWR	≤ 1.3 @ f. res.
MAX. POWER	150 W
MECHANICAL	
MATERIALS	Whip: Black-chromed stainless steel Black-chromed brass Mount: Brass Environment-proof plastics
RECOMMENDED INSTALLATION TORQUE	6.5 \pm 0.5 Nm
CABLE	FME-cable to be ordered separately
COLOUR	Black
HEIGHT	Approx. 500 mm (dep. on freq.)
WEIGHT	Approx. 98 g
MOUNTING	Wing mounting using one of the three packing gaskets supplied with the mount

INSTALLATION

The SM-mount is especially designed for mounting on curved surfaces, e.g. the curved wings. The mount is supplied with three different packing gaskets to ensure the best possible adjustment to the wing contour at the desired location of the installation. Please refer to the installation steps described below. When cleaning the car in car-washing machines, the whip should be removed – a 9 mm fork spanner can be used. After wash, the whip is refitted and tightened lightly with the spanner.

INSTALLATION STEPS:

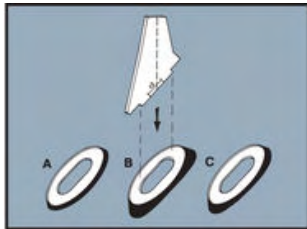

1. Installation tools.
To find a possible location for the installation of the SM-mount, the accompanying cardboard model of the mount may be used together with the three packing gaskets (types A, B and C). Which one of the packing gaskets to use depends on the angle and the curving of the wing.



2. Determine a suitable location for the installation.
Use the cardboard model of the mount together with a packing gasket to check the fitting to the wing contour at the desired installation spot. Make sure that the desired positioning angle as indicated by the dotted line on the cardboard model can be obtained for the whip. If not, try another packing gasket or try moving the model to find an acceptable location for the installation. (The packing gasket should be oriented with the letter indicating the gasket type (A, B or C) at the bottom end). Check that there are no obstacles on the inside to prevent installation.



3. Mark the position for the SM-mount.
With the cardboard model in the correct position place two marks as indicated on the figure. The distance between the marks is 13 mm and the marks are to be placed as close to the cardboard model as possible. Remove the cardboard model and the packing gasket.



4. Make the hole for the installation.
The hole for the installation is made by drilling two 17 mm dia. holes with the marks as centres. The remaining metal between the holes is removed by cutting/ripping.

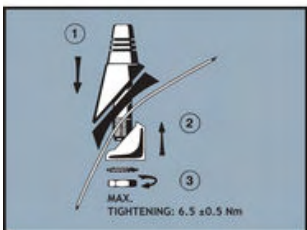

5. Install the SM-mount.
Install the SM-mount as shown in the figure. Fine-adjust the positioning of the whip before tightening the mount - recommended installation torque: 6.5 ± 0.5 Nm.



6. Fit the whip.
Fit the whip and tighten it tightly with a 9 mm fork spanner.

TUNING:

The MH 1-SMR is tunable by cutting. The antenna should always be tuned using an SWR-meter – the cutting diagrams below may serve as a guide for this procedure.

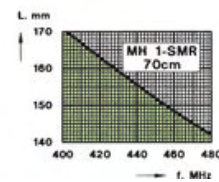
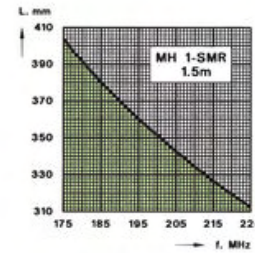
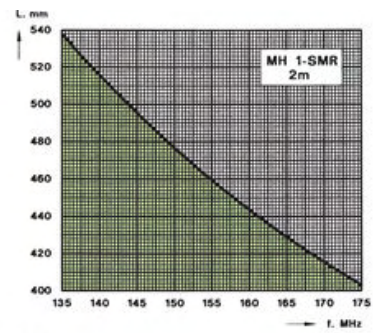

Procom A/S reserve the right to amend specifications without prior notice.



PROCOM A/S reserve the right to amend specifications without prior notice.

16/01/2009