

DFSA 4/TETRA-BZ BBMU2

Dual-frequency shortened Mobile Antenna for the 4 m and TETRA Bands

DESCRIPTION

- External antenna whip mounted on the BZ-mount.
- Stainless steel BZ-mount with ball-joint and wing screw whip-fastening system.
- Polyethylene-covered flexible whip.
- Dual-frequency mobile antenna for the 4 m and TETRA bands with two separate outputs.
- Easily removable whip for car wash.
- BZPO.1-mount permanently attached 100 mm cable terminated with FME-connector.
- Matching unit (BBMU) with 2 TNC female output connectors included.
- Separate outputs for the 4 m and TETRA bands



Hat screw option:



For antenna delivered with hat screw instead of wing screw add a K to the antenna designation.

BZPO.1-MOUNT WITH 0.1 m FME RG 58

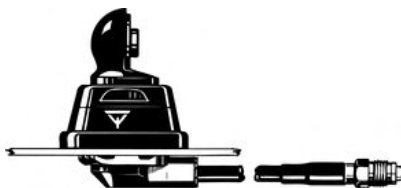

ORDERING DESIGNATIONS

TYPE	PRODUCT NO.
DFSA 4/TETRA-BZ BBMU2	130001587

SPECIFICATIONS

ELECTRICAL	
MODEL	DFSA 4/TETRA-BZ BBMU2
ANTENNA TYPE	Dual-frequency shortened mobile antenna
FREQUENCY	4 m: 73 - 80 MHz TETRA: 380 - 410 MHz
IMPEDANCE	Nom. 50 Ω
POLARIZATION	Vertical
GAIN	4 m: approx. -6 dB \pm 2 dB TETRA: approx. 1 dB (acc. to EIA RS-329-1)
SWR	≤ 1.9 in both bands
MAX. POWER	25 W
MECHANICAL	
MATERIALS	Whip: Glass fibre whip with copper wire winding, polyethylene-covered Black-chromed brass Mount: Black-chromed brass Weather- and shockproof plastics Stainless steel
RECOMMENDED INSTALLATION TORQUE	7.5 \pm 1 Nm
COLOUR	Black
HEIGHT	Approx. 670 mm
WEIGHT	Approx. 150 g
DIMENSIONS	Antenna: approx. 670 mm Connecting cable: 100 mm RG 58 with FME-conn. Matching unit: 50 x 50 x 20 mm
MOUNTING	ϕ 21 mm dia. hole (For roof thicknesses 2 mm up to 7.5 mm mounting hole should be ϕ 22 mm dia.)
ROOF THICKNESS	Max. 2.0 mm (Models up to 7.5 mm on request)

INSTALLATION

This antenna is supplied with type BZ-mount. The whip is fastened to the mount by means of our standard ball-joint and wing screw system. The adjustable ball-joint ensures that the whip can always be mounted in a vertical position independent of the angle of the installation spot.

The BZ-mount is particularly well suited for mounting on car roofs because of its ability to be installed exclusively with access from the outside. The BZ-mount for roof thicknesses from 2 mm to 7.5 mm must be mounted from the inside. However, the antenna can be installed anywhere on the car as the BZ-mount is equally well suited for mounting on e.g. trunk or wing.

1. INSTALLATION DIMENSIONS

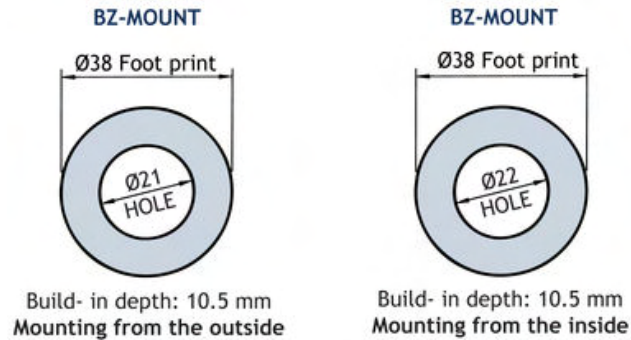

2. INSTALLATION STEPS

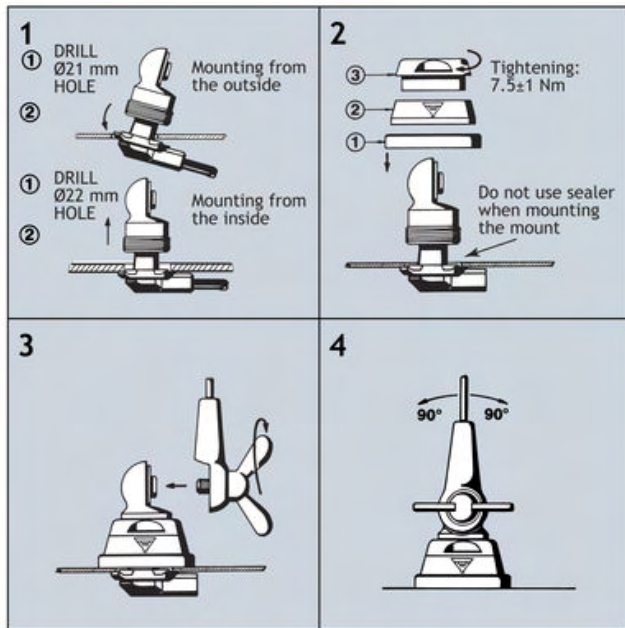

Do not use sealer on rubber gasket or other places.

PLEASE NOTE

As standard the antenna is provided with wing screw. However, the wing screw may be replaced by the less obtrusive hat screw (with key), which also gives an improved protection against theft. To order the antenna with hat screw, please add a "K" to the antenna designation.



PROCOM A/S reserve the right to amend specifications without prior notice.

01/04/2011