

HX 30-KZ

Very Short Helical Mobile Antenna
for the 30 MHz Band

PROCOM

DESCRIPTION:

- ★ Ultra-short (0.03 λ) mobile antenna for short-distance communication.
- ★ Ideal where normal-sized antennas cannot be used, as on building-site machines, forest vehicles etc.
- ★ Amazingly good performance despite a very low height, due to top loading.
- ★ Stainless steel Z-mount with ball-joint and wing screw whip-fastening system.
- ★ Simple mounting exclusively with access from the outside.
- ★ Ready-tuned and tested from the factory to assure minimum SWR.
- ★ Choice between two connection principles:
 - ★ Z-mount : FME-connection (supplied without cable).
 - ★ ZP4-mount : Permanently attached 4 m cable terminated with FME-connector.

Z-Mount

ZP4-Mount

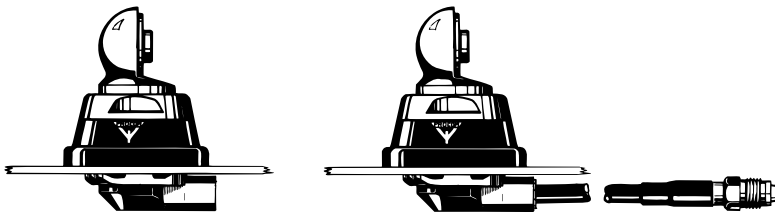

ORDERING DESIGNATIONS:

| MOUNT VERSION | Z-mount with FME-system | ZP4-mount with 4 m cable and FME connector |
|------------------|-------------------------|--|
| ANTENNA TYPE NO. | HX 30-KZ | HX 30-KZP4 |

SPECIFICATIONS:

| ELECTRICAL | |
|---------------------------------|---|
| MODEL | HX 30-KZ |
| ANTENNA TYPE | Toploaded helical mobile antenna |
| FREQUENCY | 30 MHz band |
| IMPEDANCE | Nom. 50 Ω |
| POLARISATION | Vertical |
| BAND WIDTH | ≥ 250 kHz @ SWR ≤ 2.0 |
| SWR | ≤ 1.3 @ f. res. |
| MAX. POWER | 5 watts |
| MECHANICAL | |
| MATERIALS | Whip: Electroplated steel helix moulded in elastomer Chromed brass |
| | Mount: Chromed brass Environment-proof plastics Stainless steel |
| RECOMMENDED INSTALLATION TORQUE | 7.5 \pm 1 Nm |
| COLOUR | Black |
| HEIGHT | Approx. 32 cm |
| WEIGHT | Approx. 330 g |
| MOUNTING | 21 mm dia. hole |

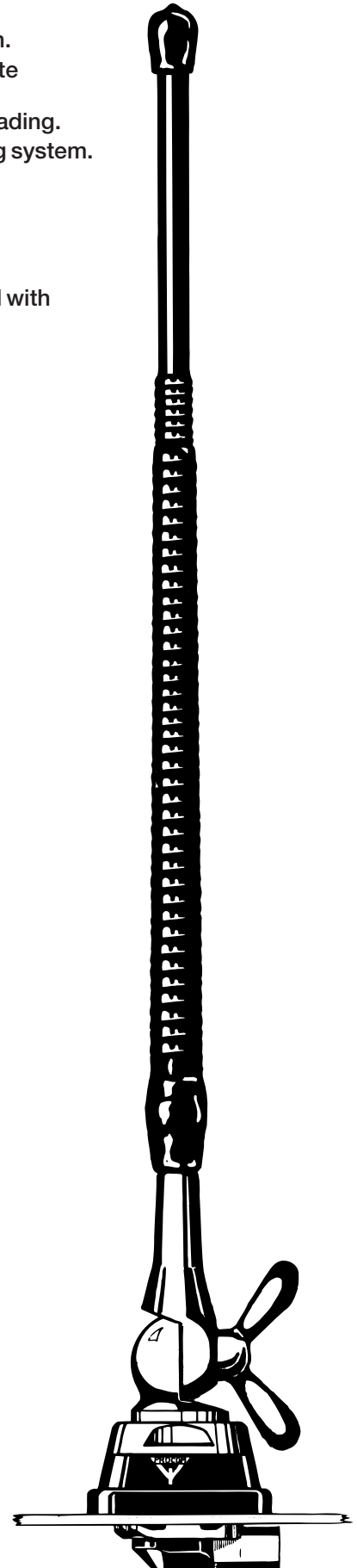

HX 30-KZ Installation



This antenna is provided with type Z-mount. The whip is fastened to the mount by means of our standard ball-joint and wing screw system. The adjustable ball-joint ensures that the whip can always be mounted in a vertical position independent of the angle of the installation spot.

The Z-mount is particularly well suited for mounting on car-roofs because of its ability to be installed exclusively with access from the outside. However, the antenna can be installed anywhere on the car, as the Z-mount is equally well suited for mounting on e.g. trunk or wing.

1. INSTALLATION DIMENSIONS:

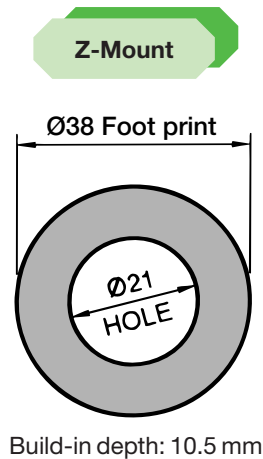

2. INSTALLATION STEPS:

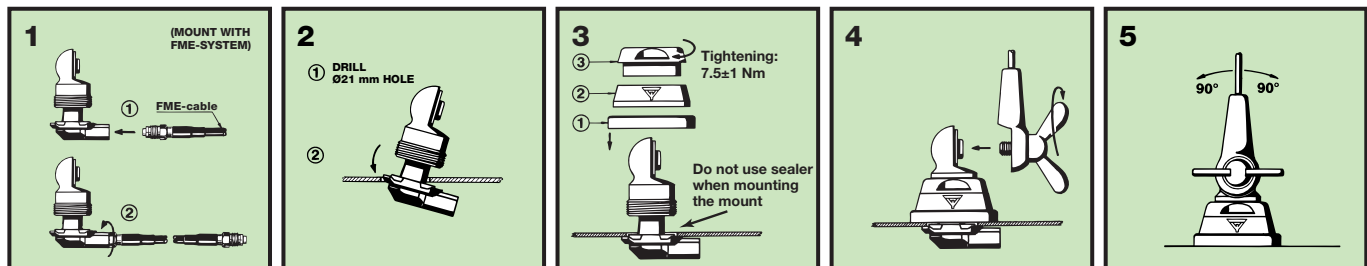

3. TUNING:

The antenna is factory-tuned for minimum SWR.
No additional tuning is required.